

Ronda 55 s

Data sheet

Details

- Fireplace insert, open on one side, Front: round
- 5545 – Height 45 cm
5551 – Height 51 cm
5557 – Height 57 cm
- Glass radius: 300 mm
- Self-closing door
- Adjustable lower air washing
- Standard fire box inner lining: smooth beige chamotte
- High-grade cast-iron dome, all parts can be moved, adjustable between 0 – 90°
- Overall height can be simply and quickly adjusted
- Easy to dismantle for transport



Ronda 55 with hinged front

Technical data

| | |
|---|--------------|
| Nominal heat output | 7 kW |
| Thermal output range | 3,3 – 8,7 kW |
| Efficiency | >78 % |
| Insulation thickness (with wall that does not need to be protected) (based on SILCA® 250KM) | 60 mm |
| Combustion air connector | Ø 125 mm |
| Recommend length of logs | 33 cm |
| Weight | 180 – 200 kg |
| Heat distribution through the viewing window | 35 % |
| Heat distribution, convective output | 65 % |

Data for chimney sweep according to DIN EN 13384 (closed operation)

Triple values with nominal heat output

| | |
|----------------------------|---------|
| Flue gas mass flow | 5,9 g/s |
| Flue gas temperature | 340 °C |
| Required delivery pressure | 12 Pa |

Triple values for calculating ceramic flues (wood fuel)

| | |
|---|-------|
| Firing power | – |
| Flue gas mass flow | – |
| Flue gas temperature upstream of the connecting surface | – |
| Required delivery pressure at the flue gas connector | – |
| Combustion air requirement | – |
| Recommended flue length ¹ | 1,7 m |

Data for closed design

| | |
|--|--------------------|
| Minimum heat-emitting surface ² | 3,3 m ² |
|--|--------------------|

¹The information regarding flue lengths is a recommendation and based on the calculation in accordance with Tröl 2020 chapter 15. The calculation is based on a medium-heavy design and a flue ratio of 360 cm².

²Average value based on the storage time. Dependent on the material properties and the construction thickness. Mean specific heat distribution = approx. 500 W/m²

There may be modifications to the colour and technical details caused by ongoing developments; subject to errors and omissions. Dated: 01/2022

Standard



Anthracite front



Door hinge on left



Door hinge on right



125 mm
Combustion air connector

Optional



External fuel-door



150 mm
Combustion air connector

Accessories



Heat exchanger



Top mounted heat exchanger



Hot air top-mounted element



Hot water top-mounted element R



SMR



Energy efficiency class in accordance with (EU) 2015/1186



1. Federal Emissions Control Ordinance Stage 2



Ronda 55 s

Dimensional drawing

Front view, scale 1:20

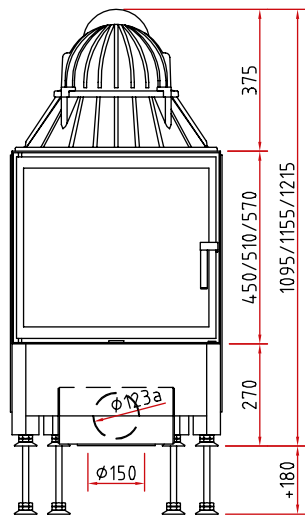

Side view, scale 1:20

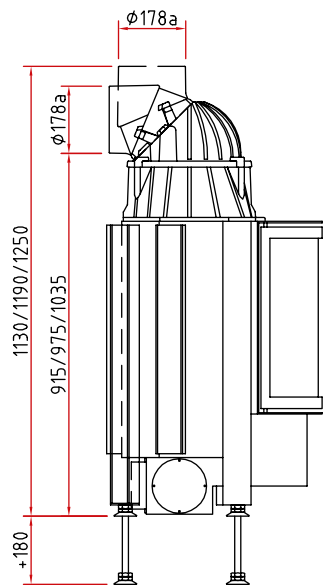

Top view, scale 1:10

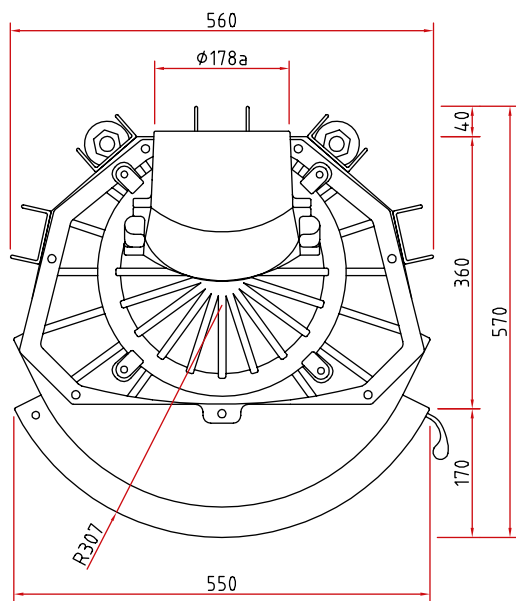

Illustrations are similar. All photos and drawings are protected by copyright. Usage or publication, even of individual details, is only permitted with our authorisation. There may be modifications to the colour and technical details caused by ongoing developments; subject to errors and omissions. Dated: 07/2017

Product data sheet

Regulation (EU) 2015/1186 supplementing Directive 2010/30/EU

| | Ronda 55 s/h |
|---|---|
| Supplier's name: | Camina & Schmid Feuerdesign und Technik GmbH & Co. KG |
| Supplier's model identifier: | Ronda 55 s/h |
| Energy efficiency class: | A |
| Direct heat output (kW) | 7,0 |
| Indirect heat output (kW): | – |
| Energy efficiency index (EEI): | 105,0 |
| Energy efficiency at nominal heat output (%): | 79,3 |
| Notes for specific precautions, installation or maintenance: | Please note the reference in the assembly instructions and operating manuals! |

There may be modifications to technical details caused by ongoing developments; subject to errors and omissions. Dated: 11/2021



ENERG
енергия · ενέργεια



Camina  Schmid Ronda 55 s/h

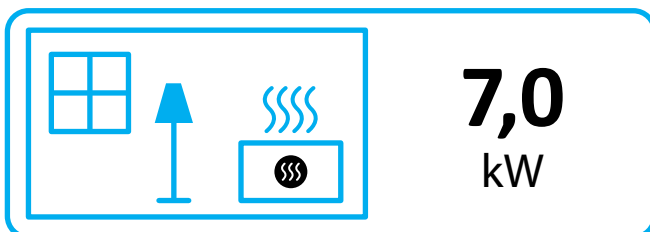
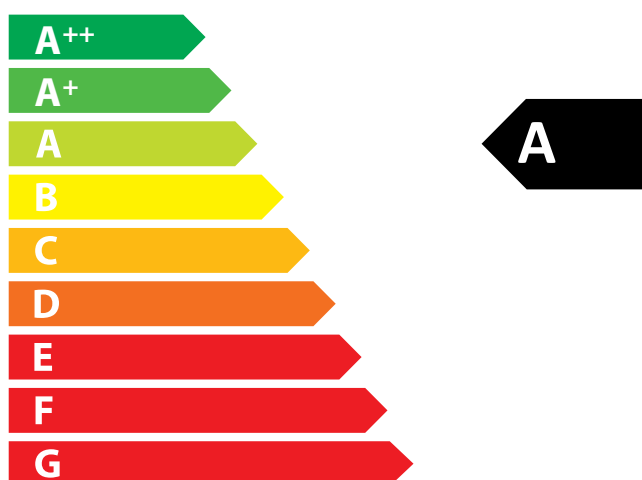

ENERGIA · ЕНЕРГИЯ · ΕΝΕΡΓΕΙΑ · ENERGIJA · ENERGY · ENERGIE · ENERGI

2015/1186